

# SUITES FOR LEASE

## Specification:

- 1 and 2-story office building
- Available floor size from 2,710 square feet
- 4.8 parking per 1,000 square feet

## Building Locations:

- Relief from traffic and parking hassles in other Tampa office markets. People want to avoid the traffic in Westshore and the parking decks downtown
- The I-75 location provides excellent access to retail shopping, restaurants, banks and hotels
- 1.5 miles from I-75

## Building Features:

- Efficient floor plates and column spacing
- Fiber optics
- Extensive landscaping
- New construction
- Individual suite access
- Immediate occupancy



For more information  
please contact:

813.977.5201  
Ext. 2



12570 Telecom Drive  
Tampa, FL 33637  
813.977.5201

[www.unitedamericanrealty.com](http://www.unitedamericanrealty.com)

12570  
Telecom Park  
SUITES FOR LEASE



12570 TELECOM PARK, INC.



# 12570 Telecom Park

AVAILABLE SUITES	
SUITE	SQ. FT.
B	1,567
C	993
B & C	2,560
E	2,710

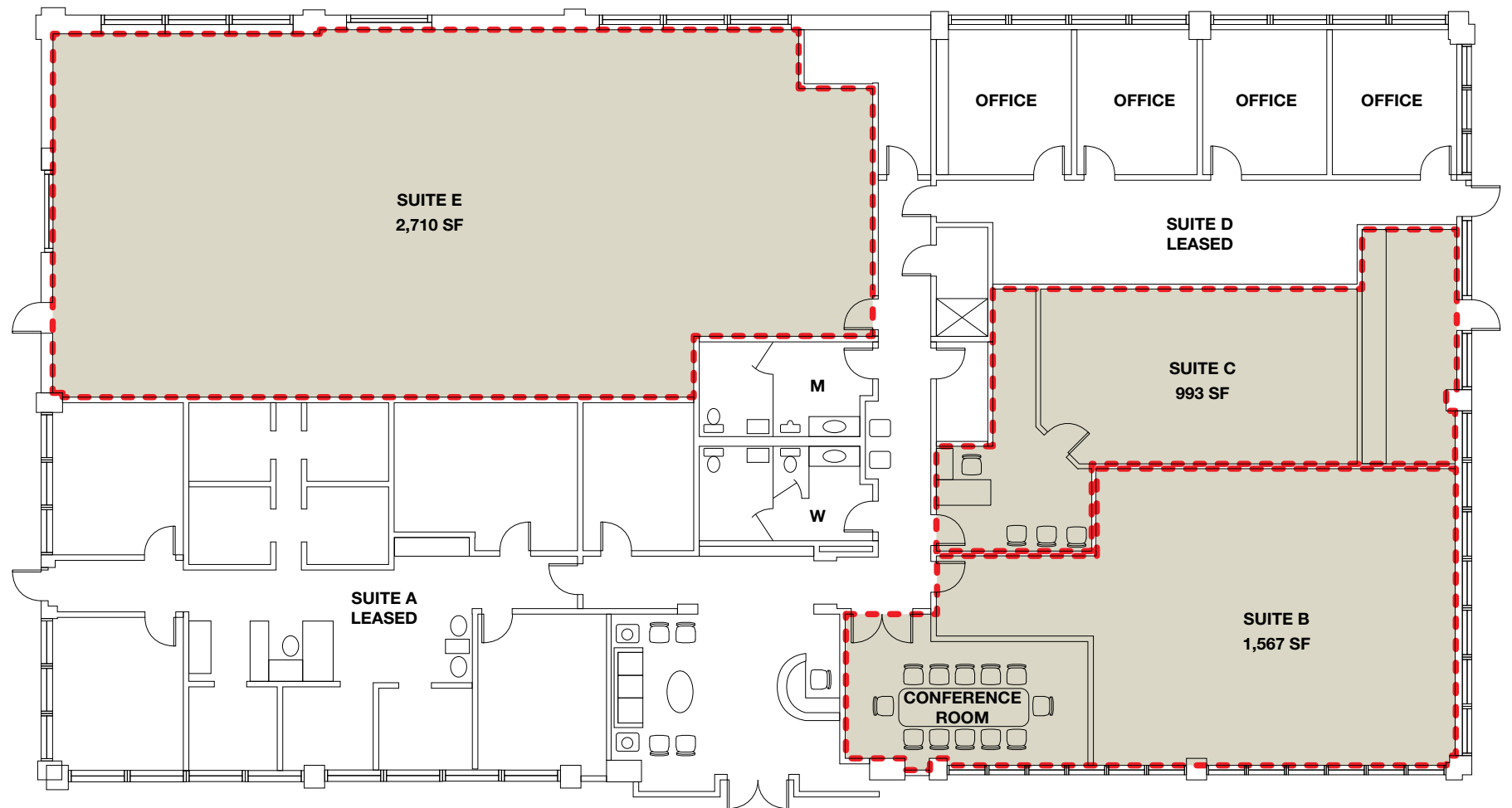

Square footages are estimated. Refer to survey contained in condominium for actual measurements.